

Drawing file: DWG 10-14 - LF Develop Stacking May 27, 2009 - 4:31pm

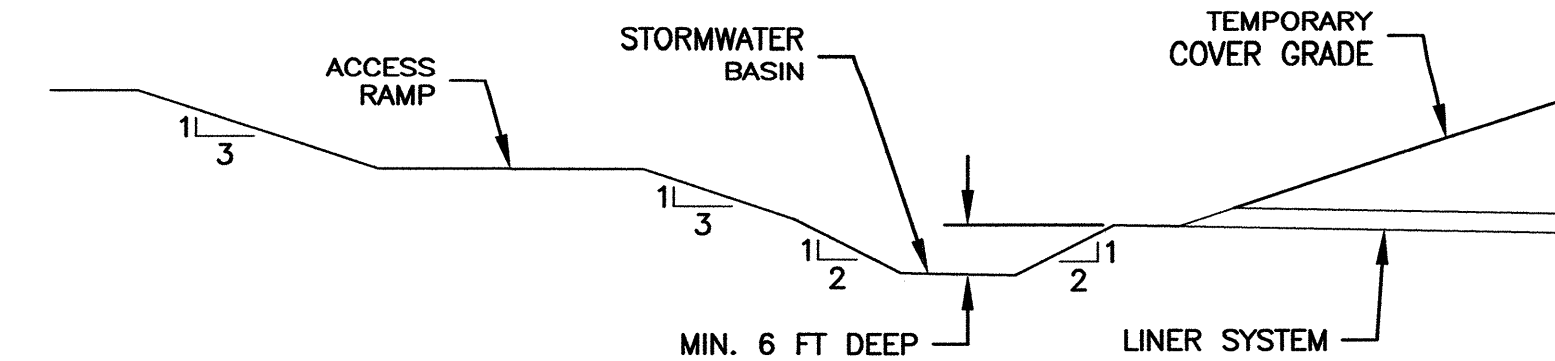

2
TYPICAL TEMPORARY LANDFILL STORMWATER BASIN DETAIL

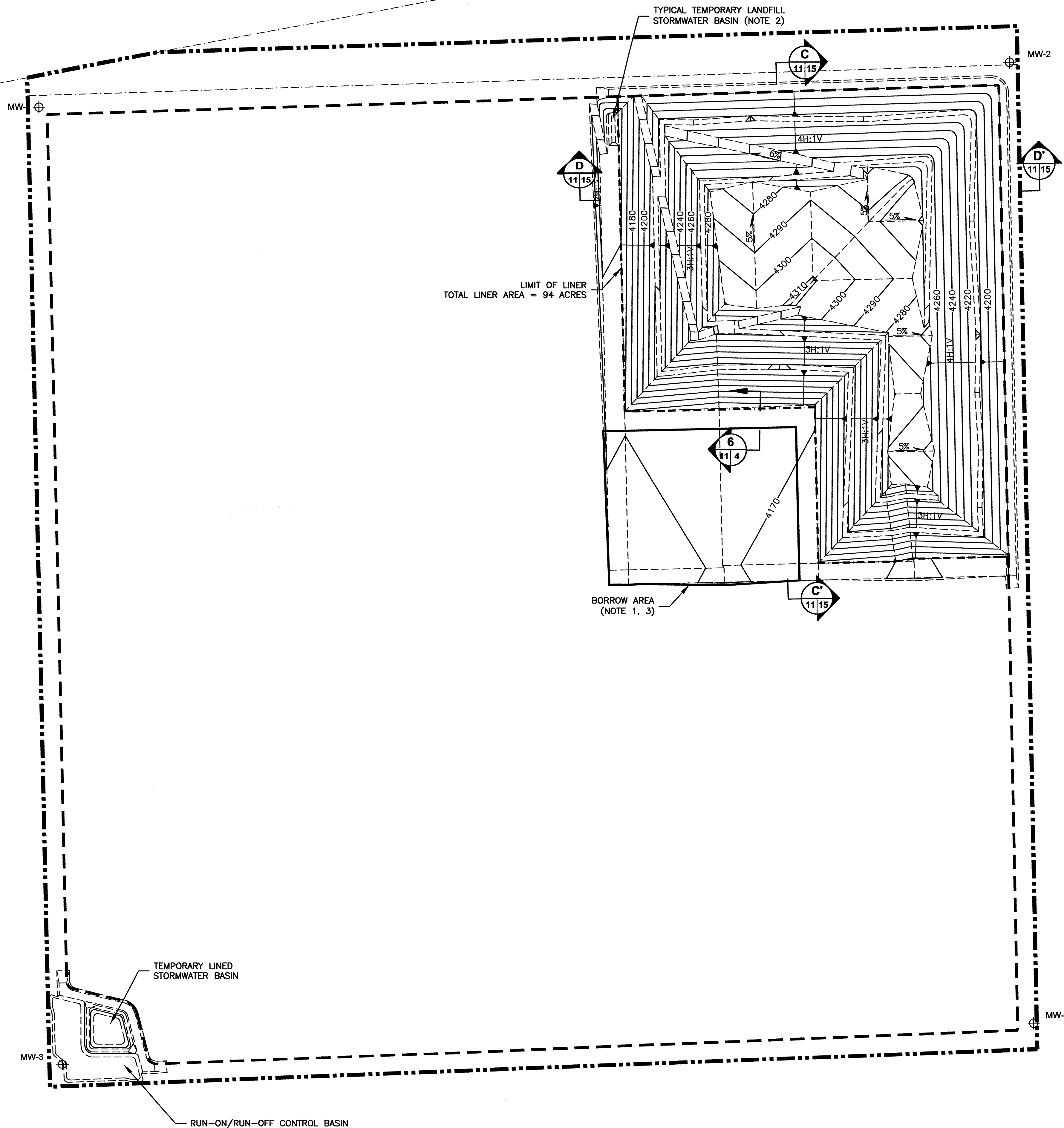
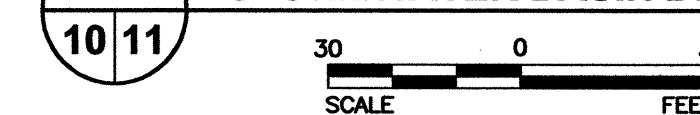

LEGEND

- PROPERTY BOUNDARY
- LIMIT OF LANDFILL
- LIMIT OF LINER
- BORROW AREA
- ⊕ MW-1
- 14% GRADE INDICATOR
- 3H:1V SLOPE INDICATOR
- DETAIL/SECTION DESIGNATION
- ⊕ A 3 6 DRAWING WHERE SECTION/DETAIL IS LOCATED
- ⊕ A 3 6 DRAWING WHERE SECTION/DETAIL IS REFERENCED

NOTES

1. BORROW AREA GRADES SHOWN REPRESENT THE MAXIMUM EXCAVATION (MINIMUM ELEVATIONS) OF SOIL REMOVAL PRIOR TO SUBSEQUENT LINER SYSTEM CONSTRUCTION.
2. TEMPORARY LANDFILL STORMWATER BASIN WILL COLLECT STORMWATER RUN-OFF FROM THE ACTIVE DISPOSAL AREA. THE WATER IN THIS BASIN WILL BE PUMPED AND ROUTED TO THE TEMPORARY LINED STORMWATER BASIN WHERE IT WILL BE SAMPLED AND TESTED. IF IT IS FREE OF WASTE CONSTITUENTS, THE WATER WILL BE DISCHARGED TO THE UNLINED RUN-ON/RUN-OFF CONTROL BASIN.
3. STORMWATER RUN-OFF WITHIN THE BORROW AREA WILL BE ROUTED TO A TOPOGRAPHIC LOW POINT WITHIN THE BORROW AREA WHERE IT WILL BE STORED UNTIL IT EVAPORATES OR INFILTRATES INTO THE SUBSURFACE SOILS.

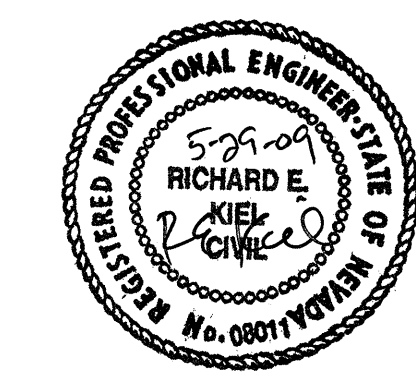
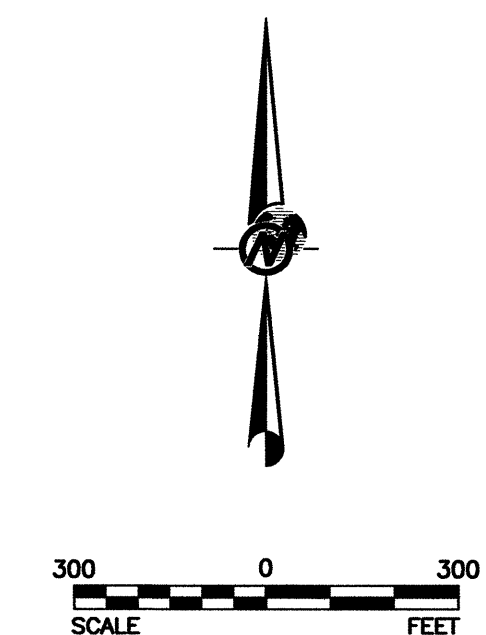

REV	DATE	DES	REVISION DESCRIPTION	CADD	CHK	R/W
Δ	05/29/09	KGH	REVISED DEVELOPMENT SEQUENCE		KGH	REK
Δ	03/11/08	KDH	ISSUED FOR PERMITTING	RJS	KGH	REK

PROJECT
JUNGO ROAD LANDFILL
WINNEMUCCA, HUMBOLDT COUNTY, NEVADA

TITLE
CELL DEVELOPMENT PLAN
END OF YEAR 10

Golder Associates Sacramento, CA	PROJECT	No. 063-7079-100	FILE No. DWG 10-14 LF Develop Seq
	DESIGN	KGH 10/01/07	SCALE AS SHOWN REV. B
	CADD	JDR 03/05/08	
	CHECK	KGH 03/06/08	
	REVIEW	REK 03/08/08	
			11